



**ANCHOR**<sup>TM</sup>  
BUILD SOMETHING BEAUTIFUL

Anchor Wall Engineering, LLC  
5959 Baker Road, Suite 390  
Minnetonka, MN 55345

These graphic representations are intended for preliminary design purposes only and are not to be used for construction without the signature of a registered professional engineer.

©2008 Anchor Wall Engineering, LLC  
® and <sup>TM</sup> Anchor Wall Systems, Inc.

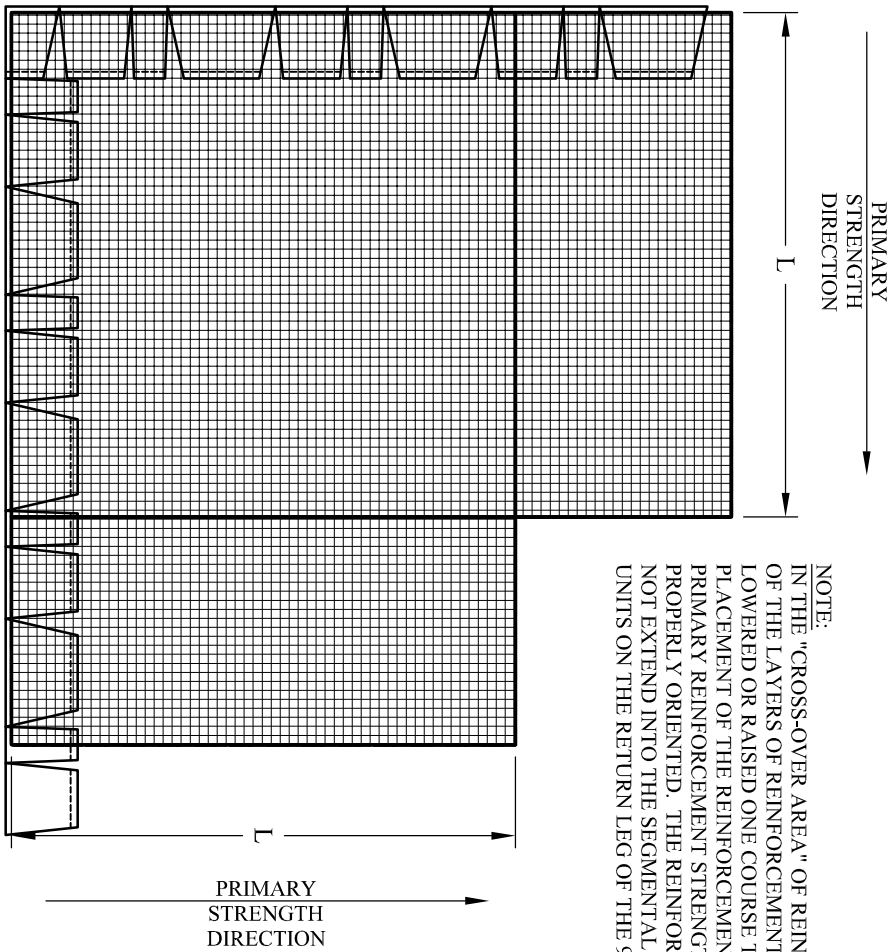

NOTE:  
 IN THE "CROSS-OVER AREA" OF REINFORCEMENT, ONE OF THE LAYERS OF REINFORCEMENT SHOULD BE LOWERED OR RAISED ONE COURSE TO ALLOW PLACEMENT OF THE REINFORCEMENT WITH THE PRIMARY REINFORCEMENT STRENGTH DIRECTION PROPERLY ORIENTED. THE REINFORCEMENT SHOULD NOT EXTEND INTO THE SEGMENTAL RETAINING WALL UNITS ON THE RETURN LEG OF THE 90-DEGREE CORNER.

Drawn By: AWE

Date: 3/18/2008

Scale: 3/8"=1'-0"

Drawing Title:

Highland Stone<sup>®</sup> Retaining Walls  
90-Degree Outside Corner With Grid

Project Information:

Typical Retaining Wall Details  
www.anchorwall.com